

Park Lane Hotel

ASTINS

Project Profile

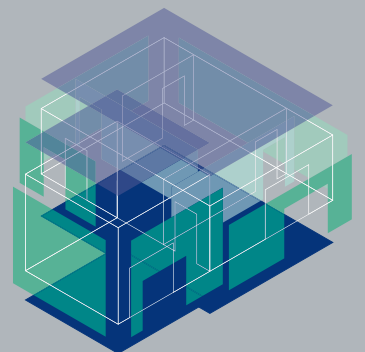



Project Profile

22 Park Lane , London W1

Main Contractor

John Mowlem & Company

Package Value

£2,500,000

Commencement Date

August 2001

Duration

74 weeks

Sector

Public Buildings/Hotels

Scope of Work

Dry lining, partitions and ceilings

