

Century House

ASTINS

Project Profile

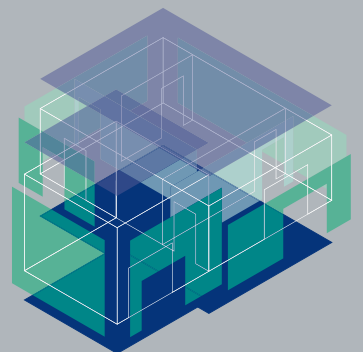



Project Profile

Century House,
100 Westminster Bridge Road, London SE1

Main Contractor

Pearce Construction

Package Value

£3,200,000

Commencement Date

June 2000

Duration

60 weeks

Sector

Residential/Fit Out

Scope of Work

Dry lining, partitions and ceilings

