

BAE, Luton, Bedfordshire

# ASTINS

Project Profile

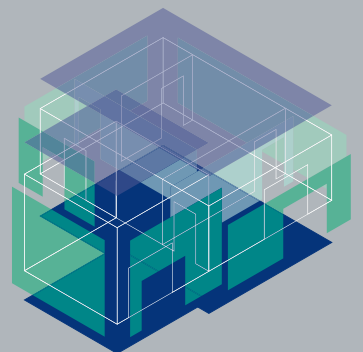



## Project Profile

BAE, Luton, Bedfordshire

## Main Contractor

Mowlem Major Projects

## Package Value

£1,700,000

## Commencement Date

September 2003

## Duration

65 weeks

## Sector

Commercial

## Scope of Work

Dry lining, partitioning and ceilings

